

W432 BP530 3/4/05

**OPERATION MANUAL
21 INCH WOODWORKING BAND SAW**

**FOR YOUR
SAFETY**
READ ALL
INSTRUCTIONS
CAREFULLY



TABLE OF CONTENTS:

| Section | Page |
|--|-------|
| General Specification/Wiring Diagrams..... | 1 |
| Operation Warnings..... | 2 |
| Safety Instructions for Operation..... | 3 |
| Parts list Band Saw (Front)..... | 4 |
| Parts list Band Saw (Rear)..... | 5 |
| Operating Instructions..... | 6 |
| Moving..... | 6 |
| Assemble The Machine..... | 6 |
| Adjusting 90 degree Table Stop..... | 6 |
| Rip Fence..... | 6 |
| Blades change..... | 7 |
| Adjusting Upper Blade Guide Assembly..... | 7 |
| Adjusting the Speed of Saw Blade..... | 8 |
| Adjusting the Tension of the Blade..... | 8 |
| Dust Collection..... | 8 |
| Setting the cutting height..... | 8 |
| Miter Gauge Adjustment..... | 9 |
| Parts List (Model No . SBW-5300 A)..... | 10-16 |
| Diagram..... | 17-18 |
| Parts List (Model No . SBW-5300 CE)..... | 19-25 |
| Diagram..... | 26-27 |
| Parts List (Model No . QF198004)Rip Fence..... | 28 |
| Diagram..... | 29 |

GENERAL INFORMATION:

The 21"(530mm) band saw is a well designed industrial machine that provide variety of wood working functions to meet your higher needs of a Band Saw. Followings are the basic functions you will find in this machine:

1. *Quick Changed Saw Blade system* given you an easy way to replace saw blade to cut different quality wood materials.
2. *Adjustable Rip Fence* can assist you to cut desired shapes.
3. *Accurate Miter Gauge* can let you create any curves you desire.
4. *Effective Ball Bearing Guide System* will let the band saw blade run more smoother.
5. *Humanized Dust Chutes* collect extra wood-chips, and give you a better working environment.
6. *Extended 12" Height Space* provides you a bigger working space to cut wider and higher wood selections.

1. General Specifications

| | |
|-------------------------------------|------------------------------|
| Horse Power | 2HP |
| Appearance | 40" x 31" x 80" |
| Cutting Height | 12"(300mm) |
| Max. Cutting Width | 20-1/4"(514mm) |
| Max. Cutting (Rip Fence) | 18-5/8"(474mm) |
| Saw Blade (L) | 3930mm |
| Saw Blade (W) | 1/8" to 1-1/4" (Standard 1") |
| CE Saw Blade Speed, Saw Blade Speed | (1890, 3800SFPM) |
| Table Size | 21" x 21"(530x530mm) |
| Table Tilting | Left-10° / Right-45° |
| Wheel Size | 21"(530mm) |
| Table Height From Ground | 37.5"(950mm) |
| Dust Chute Diameter | D4" x 2 |
| N.W/G.W. | 163 / 196kgs |
| Packing Size (LxWxH) | 37" x 20" x 87"(38CUFT) |
| CTN QTY / 20" / 40" | 24SETS / 50SETS |

WIRING DIAGRAMS:

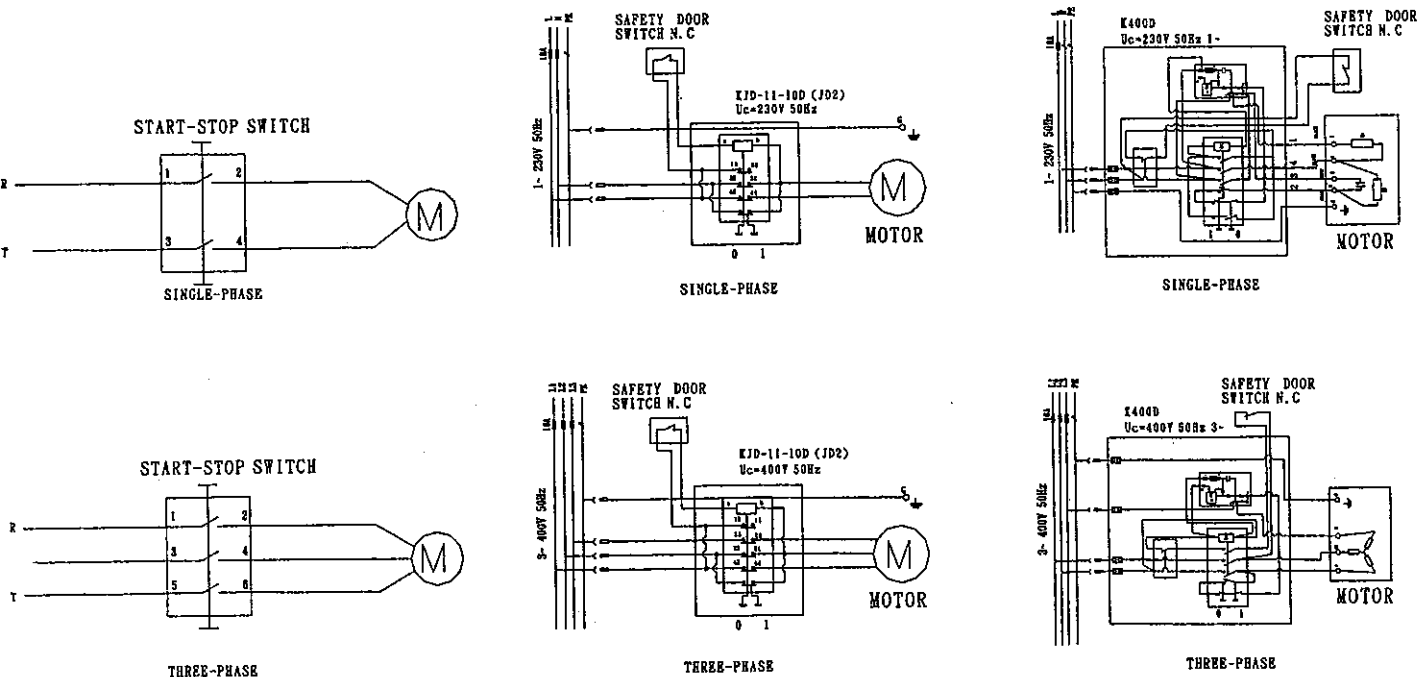

2. WARNINGS



WARNING

- Misuse of this machine can cause serious injury.
- For safety, machine must be set up, used and serviced properly.
- Read, understand and follow instructions in the operator's and parts manual which was shipped with your machine.

When setting up machine:

- Always avoid using machine in damp or poorly lighted work areas.
- Always be sure machine is securely anchored to the floor.
- Always keep machine guards in place.
- Always put start switch in "OFF" position before plugging in machine.

When using Machine:

- Never operate with machine guards missing.
- Always wear safety glasses with side shields (See ANSI Z87.1)
- Never wear loose clothing or jewelry.
- Never overreach - you may slip and fall into the machine.

- Never leave machine running while you are away from it.
- Always shut off the machine when not in use. When servicing machine:
- Always unplug machine from electrical power while servicing.
- Always follow instructions in operators and parts manual when changing accessory tools or parts.
- Never modify the machine without consulting Wilton Corporation.

You - the stationary power tool user - hold the key to safety.

Read and follow these simple rules for best results and full benefits from your machine. Used properly, Wilson's machine is among the best in design and safety. However, any machine used improperly can be rendered inefficient and unsafe. It is absolutely mandatory that those who use our products be properly trained in how to use them correctly. They should read and understand the Operators and Parts Manual as well as all labels affixed to the machine. Failure to follow any of these warnings can cause serious injuries.

Machinery general safety warnings

1. Always wear protective eye wear when operating machinery. Eye wear shall be impact resistant, protective safety glasses with side shields which comply with ANSI Z87.1 specifications. Use of eye wear which does not comply with ANSI Z87.1 specifications could result in severe injury from breakage of eye protection.
2. Wear proper apparel. No loose clothing or jewelry which can get caught in moving parts. Rubber soled footwear is recommended for best footing.
3. Do not overreach. Failure to maintain proper working position can cause you to fall into the machine or cause your clothing to get caught-pulling you into the machine.
4. Keep guards in place and in proper working order. Do not operate the machine with guards removed.
5. Avoid dangerous working environments. Do not use stationary machine tools in wet or damp locations. Keep work areas clean and well lit. Special electricians should be used when working on flammable materials.
6. Avoid accidental starts by being sure the start switch is "OFF" before plugging in the machine.
7. Never leave the machine running while unattended. Machine shall be shut off whenever it is not in operation.
8. Disconnect electrical power before servicing. Whenever changing accessories or general maintenance is done on the machine, electrical power to the machine must be disconnected before work is done.
9. Maintain all machine tools with care. Follow all maintenance instructions for lubricating and the changing of accessories. No attempt shall be made to modify or have makeshift repairs done to the machine. This not only voids the warranty but also renders the machine unsafe.
10. Machinery must be anchored to the floor.
11. Secure work. Use clamps or a vise to hold work, when practical. It is safer than using your hands and it frees both hands to operate the machine.
12. Never brush away chips while the machine is in operation.
13. Keep work area clean. Cluttered areas invite accidents.
14. Remove adjusting keys and wrenches before turning machine on.
15. Use the right tool. Don't force a tool or attachment to do a job it was not designed for.
16. Use only recommended accessories and follow manufacturers instructions pertaining to them.
17. Keep hands in sight and clear of all moving parts and cutting surfaces.
18. All visitors should be kept at a safe distance from the work area. Make workshop completely safe by using padlocks, master switches, or by removing starter keys.
19. Know the tool you are using- its application limitations, and potential hazards.

Safe by using padlocks, master switches, or by removing starter keys.

General Electrical Cautions

This saw should be grounded in accordance with the National Electrical Code and local codes and ordinances. This work should be done by a qualified electrician. The saw should be grounded to protect the user from electrical shock.

3. SAFETY INSTRUCTIONS

1. Always wear leather gloves when handling saw blade.
The operator shall not wear gloves when operating the machine.
2. All doors shall be closed, all panels replaced, and other safety guards in place prior to the machine being started or operated.
3. Be sure that the blades is not n contact with the workpiece when the motor is started. The motor shall be started and you should allow the saw to come up to full speed before bringing the saw blade into contact with the workpiece.
4. Keep hands away from the blade area. **See Figure A.**
5. Remove any cut off piece carefully while keeping your hands free of the blade area.
6. Saw must be stopped and electrical supply must be cut off before any blade replacement or adjustment of blade support mechanism is done, or before any attempt is made to change the drive belts or before any periodic service or maintenance is performed on the saw.
7. Remove loose performed on the unnecessary workpieces from area before starting machine.

19. Know the tool you are using - its application, limitations, and potential hazards.

Caution : For circuits which are far away from the electrical service box, the wire size must be increased in order to deliver ample voltage to the motor. To minimize power losses and to prevent motor overheating and burnout, the use of wire sizes for branch circuits or electrical extension cords according to the following table is recommended.

8. Bring adjustable saw guides and guards as close as possible to the workpiece.
9. Always wear protective eye wear when operating, servicing, or adjusting machinery. Eyewear shall be impact resistant, protective safety glasses with side shields complying with ANSI Z787. 1 specifications. Use of eye wear which does not comply with ANSI 1 specifications could result in severe injury from breakage of eye protection. **See Figure B.**
10. Nonslip footwear and safety shoes are recommended. **See Figure C.**
11. Wear ear protectors (plugs or muffs) during extended periods of operation. **See Figure D.**
12. The workpiece, or part being sawed, must be securely clamped before the saw blade enters the workpiece.
13. Remove cut off pieces carefully, keeping hands away from saw blade.
14. Saw must be stopped and electrical supply cut off or machine unplugged before reaching into cutting area.
15. Avoid contact with coolant, especially guarding your eyes.

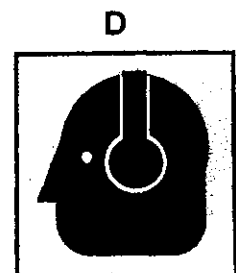
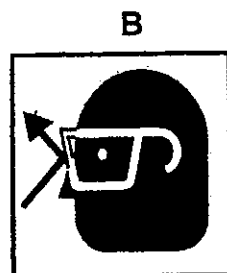

SAW NOMENCLATURE

Throughout this document, we make reference to various systems and components on the saw. The two illustrations on these pages will provide you with an overall frame of reference for the location and position of the various components.

Where detailed illustrations for various subsystems will be helpful, you will find these illustrations accompanying the specific test for each subsystem and its components.

FRONT SIDE OF BAND SAW

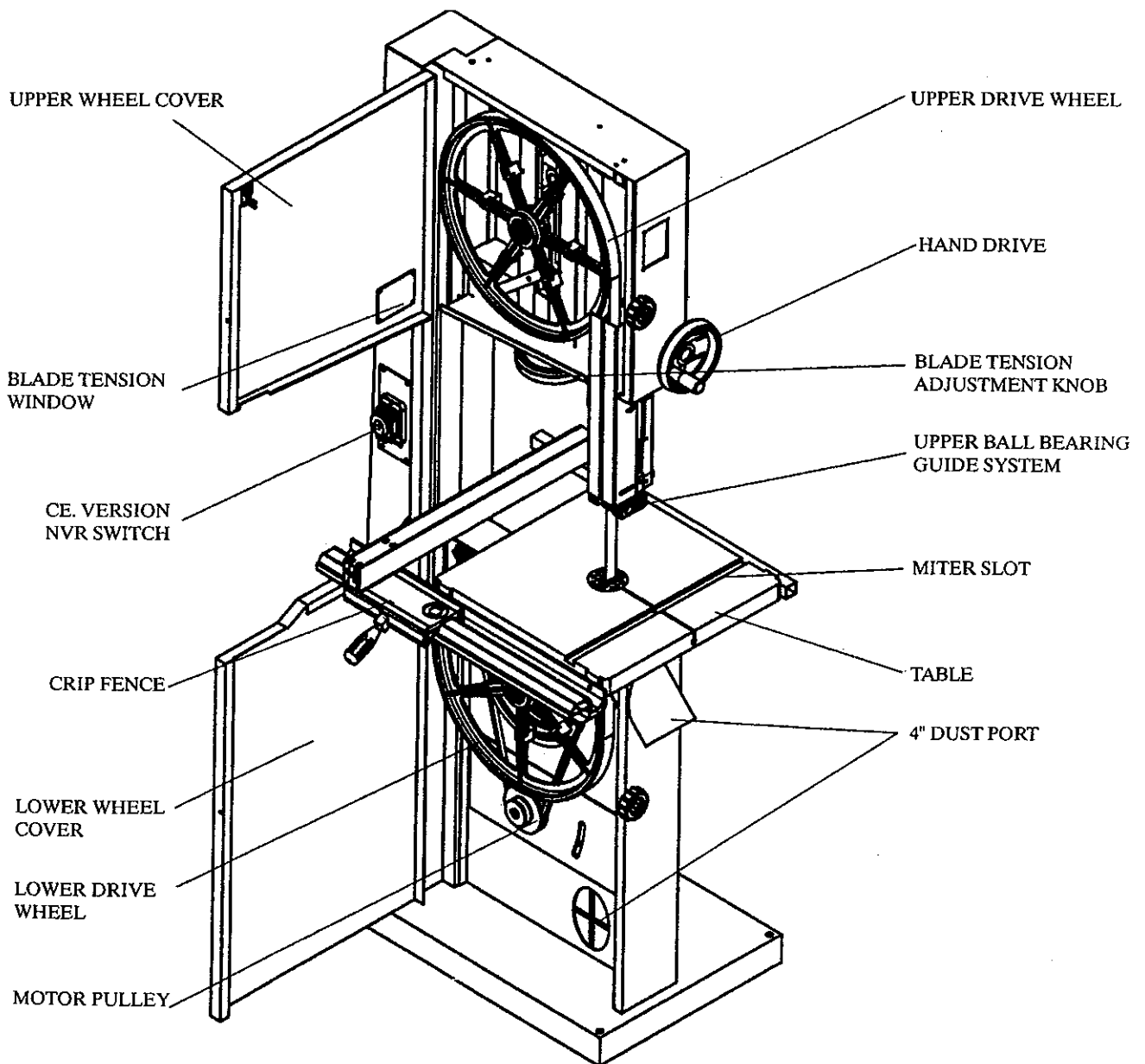

REAR OF BAND SAW

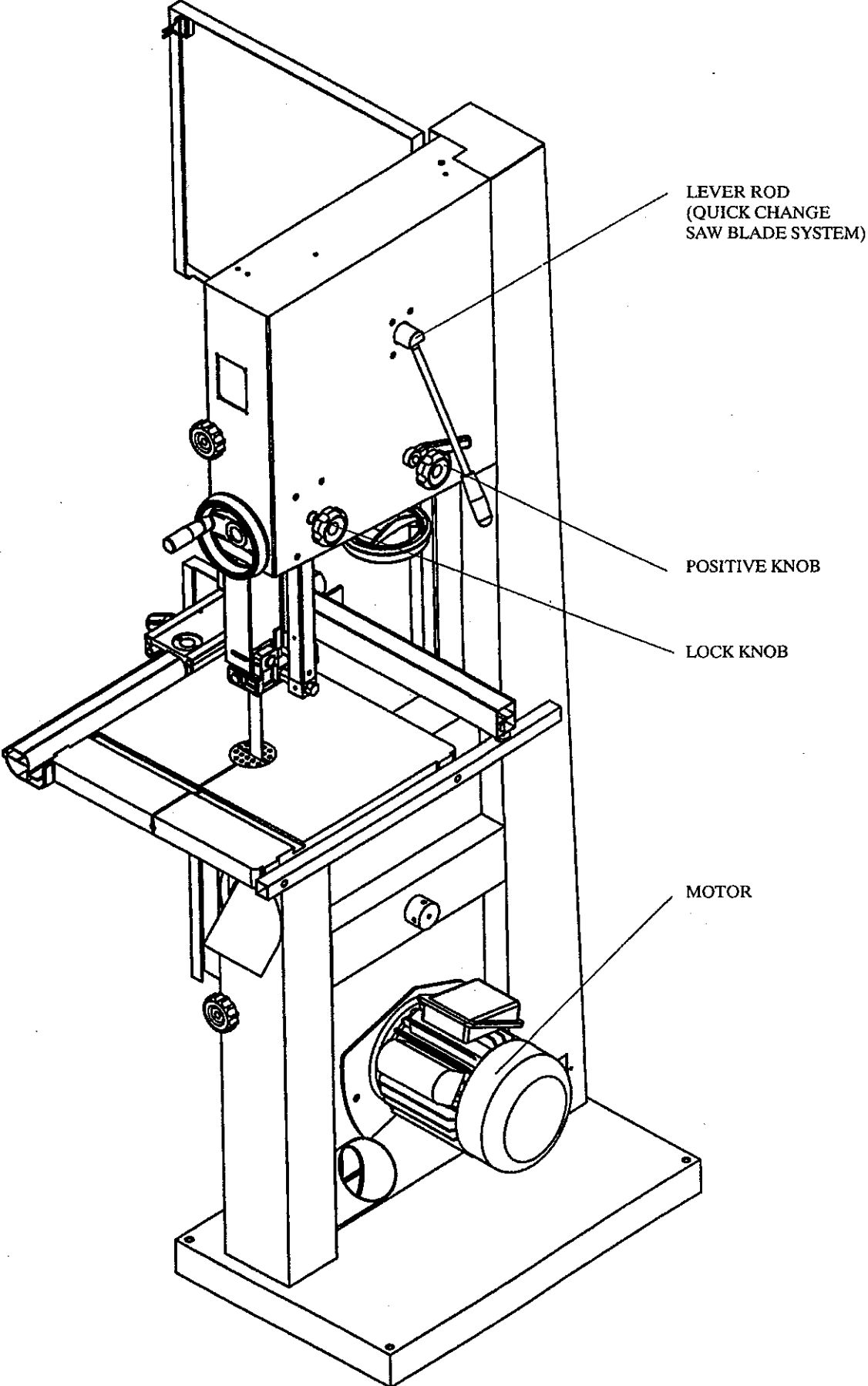

5. OPERATING INSTRUCTION

MOVING

- a. Use a 2000kgs wrecker hang up the machine on parts A (Fig. 1) to suitable space.
- b. To ensure sufficient upright stability of the machine and safety, you need to bolt the machine to floor on M10 screw.

ASSEMBLE THE MACHINE:

1. Attach the handle (A, Fig. 2) to the hand wheel (B, Fig. 2), lock the screw then connect to the machine.
2. To mount table, remove table insert and table pin from the table. Slide the table slot to the saw blade, slow moving to the center to table, make sure the table is located to the m8 hole (4 hole) and attach the spring washer, (Fig. 3) then replace table insert and table pin.
3. Adjust the table until the saw blade in the center of table insert, then locked with screw.

ADJUSTING 90 DEGREE TABLE STOP

1. Unplug power cord.
2. Loosen the lock knobs (A, Fig. 4) and tilting table left until it rests against table stop bolt M8. (A, Fig. 5)
3. Use a protractor placed on the table and against the blade, (A, Fig. 6) to see if the table is 90 degree to the table.
4. If it is not 90 degree, you can use micro-adjust knob, please lock the lockknob.

RIP FENCE

1. Setting the fixed base (A, Fig. 7) to the cast iron table with two hex head bolt m6x20, two spring washer m6.
2. Setting the square tube (B, Fig. 7) to the table with 2 hex socket bolt m6x16.
3. Setting the fence (A, Fig. 7) to the fence body, place the fence assembly on the fixed base, slide the fence on its guides until it is the required distance from the blade.
4. Check the scale, make sure the distance between the edge of the miter slot and both the front and rear of the rip fence, adjust so both distances are equal.
5. Lock the fence by pushing the locking handle.

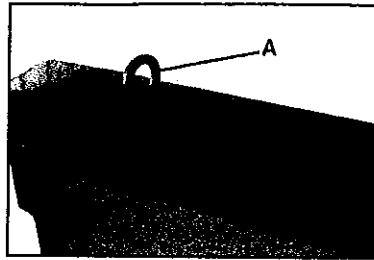

Fig. 1

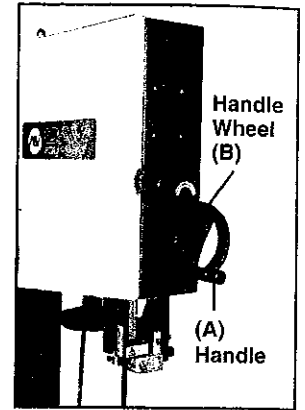

Fig. 2



Fig. 3

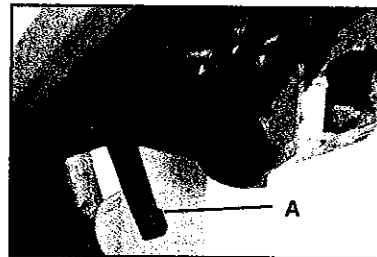

Fig. 4

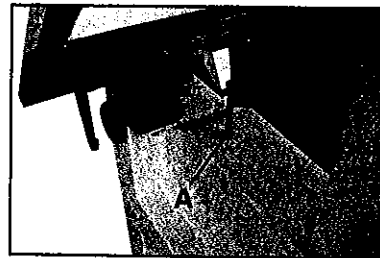

Fig. 5

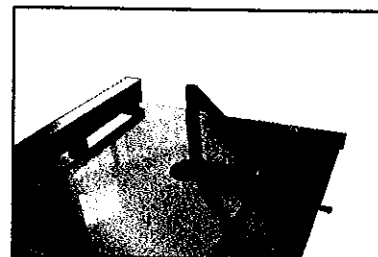

Fig. 6

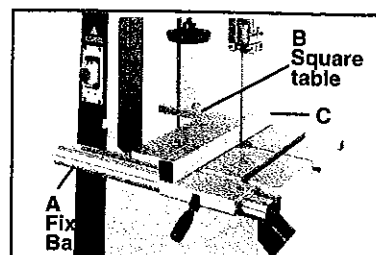

Fig. 7

BLADES CHANGING

1. Unplug power cord.
2. Remove the table insert and table pin.
3. Open upper & lower wheel cover.
4. Loosen the upper & lower blade guide system and bearing.
5. Loosen lever rod the knob (quick change saw blade system) on rear of band saw. (A, Fig. 8)
6. Remove the table to direct through slot in table.

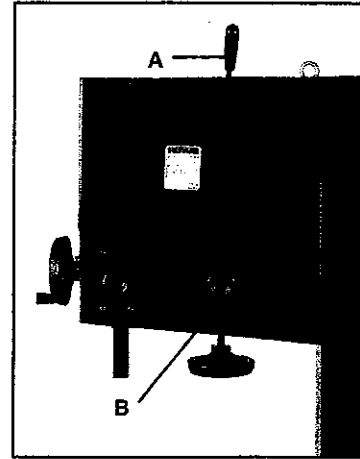

Fig. 8

Attention : the direction of new saw blade must be:

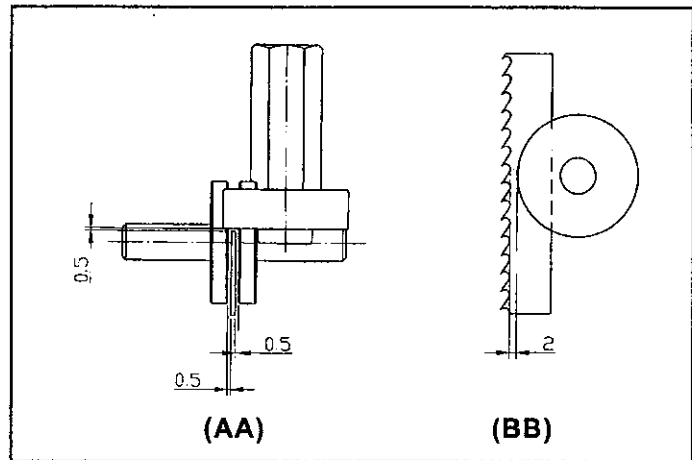
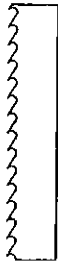

Fig. 9

7. Guide new blade through table slot, place blade in upper and lower ball bearing guide system.
8. Replace blade in the middle of the upper and lower wheel, if the saw blade is not in the right position, you must relax the fixed handle and adjust the positive knob. (B, Fig. 8)
9. Replace the table insert and table pin.
10. Adjust the blade tension and blade tacking if the blade width is different.

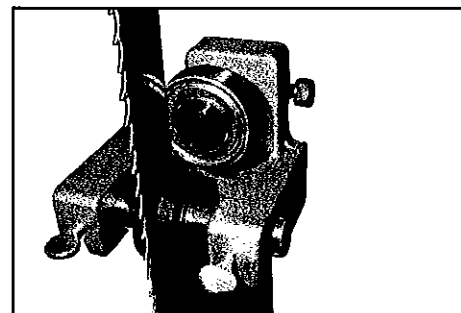

Fig. 10

ADJUSTING UPPER BLADE GUIDE ASSEMBLY

1. Set the bearing of upper & lower blade guide to within approx. 0.5mm of the blade, make sure the bearing the back of the blade approx. 0.5mm. (Fig.10,11) see follow instruction.(AA,BB)
2. Do not set the bearing too close, as the friction generates heat, which may have an adverse effect on the bearings and the saw blade as well.

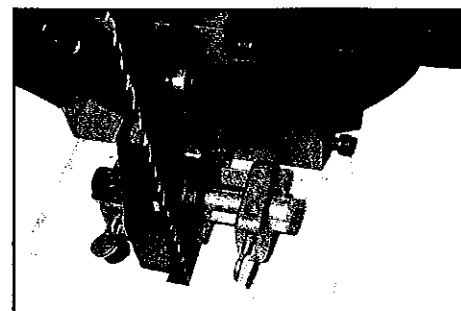

Fig. 11

ADJUSTING THE SPEED OF SAW BLADE

1. Loosen the two screw (A, B, Fig. 12), change the belt to the belt to the required belt solt.
2. Until the saw blade speed to 850m/min or 430m/min (3300SFPM, 1600SFPM)
3. Locked the two screw.

ADJUSTING THE TENSION OF THE BLADE

Blade tension is set by a spring loaded tension mechanism on the upper drive wheel. Check the level of the tension device before cutting. The tension for various blade widths as indicated on the window of upper wheel cover.

Turn the blade tension hand wheel (A, Fig. 13) and see the saw tension instruction (A, Fig. 14) indicated on the window of upper wheel cover.

DUST COLLECTION

The band saw is recommended to connected to dust collect, there are two 4" dust port (A, Fig. 15) to attach with 4" steel clamping.

SETTING THE CUTTING HEIGHT

The upper blade guide should always be set as closes practical against the work. To adjust, loosen the hand wheel (A, Fig. 2) at the side of housing and see the blade guide to the required height then tighten after setting.



Fig.12

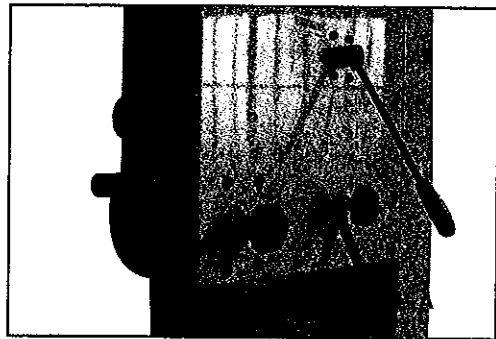

Fig.13

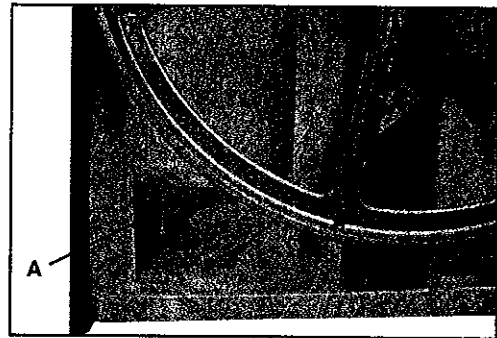

Fig.14

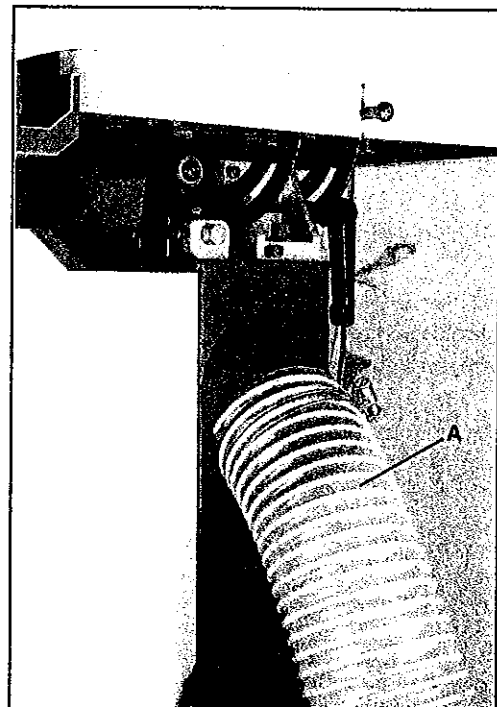

Fig.15

MITER GAUGE ADJUSTMENT (optional)

1. Plate the miter gauge in the table slot.
2. Loosen the clamp screw on the miter gauge.
3. Adjust to the desired angle of cutting on miter gauge.
4. Tighten the clamp screw (Fig. 16).

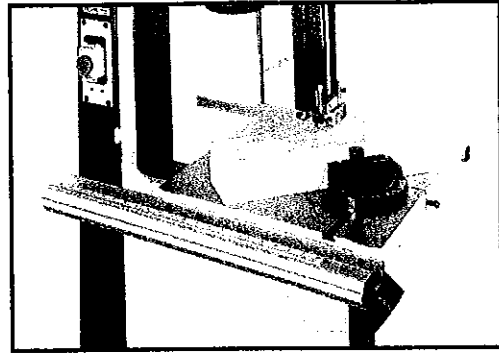

Fig. 16

**Parts List For 21 Inch Band Saw
Model No. SBW-5300 A**

| KEY NO. | PARTS NO. | DESCRIPTION | SIZE | Q'TY |
|---------|-----------|-------------------------|-----------------|------|
| 1 | | | | |
| 2 | | | | |
| 3 | | | | |
| 4 | 995101 | RING | M10 | 1 |
| 5 | 136131 | MACHINE BODY | | 1 |
| 6 | SS050100 | SET BOLT | M5x5 | 1 |
| 7 | 135067 | BUSHING | | 1 |
| 8 | WF061310 | FLAT WASHER | M6x ϕ 13 | 2 |
| 9 | IC135005 | POWER CORD | | 1 |
| 10 | NH061000 | NUT | M6 | 1 |
| 11 | 135040 | POINTER | | 1 |
| 12 | 135073 | STEP SCREW | | 1 |
| 13 | 135012 | UPPER SHAFT | | 1 |
| 14 | PS053500 | SPRING PIN | ϕ 5x35 | 1 |
| 15 | 135017 | UPPER WHEEL SHAFT HINGE | | 1 |
| 16 | 135066 | UPPER WHEEL SHAFT | | 1 |
| 17 | 135039 | BUSHING | | 3 |
| 18 | BB620403 | BALL BEARING | 6204LLU | 4 |
| 19 | 136032 | UPPER WHEEL | ϕ 21" | 1 |
| 20 | RR470000 | RETAINING RING | R47 | 4 |
| 21 | WF083030 | FLAT WASHER | M8x ϕ 30 | 2 |
| 22 | SR089400 | HEX SOCKET BOLT | M8X16 | 2 |
| 23 | 136039 | SAW BLADE | 152"x3/4"X0.5mm | 1 |
| 24 | WS080000 | SPRING WASHER | M8 | 2 |
| 25 | SR060600 | HEX SOCKET BOLT | M6x30 | 6 |
| 26 | 135040 | TIRE | | 2 |
| 27 | 136033 | LOWER WHEEL | ϕ 21" | 1 |
| 28 | 135007 | IDLE PULLEY | | 1 |
| 29 | NH633801 | NUT | 1"-14 UNF | 1 |
| 30 | WS630000 | SPRING WASHER | 1" | 1 |

| KEY NO. | PARTS NO. | DESCRIPTION | SIZE | Q'TY |
|---------|-----------|-----------------------------|----------|------|
| 31 | IM135002 | MOTOR CORD | | 1 |
| 32 | 135032 | SPRING | | 1 |
| 33 | PS031600 | PIN | φ 3X16 | 1 |
| 34 | 135042 | LOCATE BLOCK | | 1 |
| 35 | 994301 | BEARING | 51201 | 1 |
| 36 | 994542 | SWITCH | | 1 |
| 37 | 135002 | HANDLE WHEEL | | 1 |
| 38 | 136037 | ADJUSTING BOLT | | 1 |
| 39 | SF050200 | PAN HEAD BOLT W/FLANGE | M5X10 | 8 |
| 40 | WE050000 | STAR WASHER | M5 | 4 |
| 41 | SF059400 | PAN HEAD BOLT W/FLANG | M5X16 | 2 |
| 42 | NH050800 | NUT | M5 | 4 |
| 43 | 135027 | SWITCH PLATE | | 1 |
| 44 | SR089400 | HEX SOCKET BOLT | M8x16 | 2 |
| 45 | WF083030 | FLAT WASHER | M8x φ 30 | 2 |
| 46 | 135016 | UPPER WHEEL SLIDING BRACKET | | 1 |
| 47 | SR061000 | HEX SOCKET BOLT | M6x50 | 1 |
| 48 | BR000041 | RIVET | φ 3.2x6 | 8 |
| 49 | SR060200 | HEX SOCKET BOLT | M6x10 | 1 |
| 50 | 135004 | LIMPID PIECE | | 2 |
| 51 | | | | |
| 52 | | | | |
| 53 | | | | |
| 54 | | | | |
| 55 | 136038 | UPPER WHEEL COVER | | 1 |
| 56 | SH060500 | HEX SOCKET BOLT | M6x25 | 2 |
| 57 | WF061310 | FLAT WASHER | M6x φ 13 | 2 |
| 58 | 135051 | BRUSH | | 2 |
| 59 | SR060500 | HEX SOCKET BOLT | M6x25 | 1 |
| 60 | 135041 | KNOB | | 2 |

| KEY NO. | PARTS NO. | DESCRIPTION | SIZE | Q'TY |
|---------|-----------|-----------------------------------|--------|------|
| 61 | NL061000 | NYLON NUT | M6 | 4 |
| 62 | 709416 | STRAIN RELIEF | M16 | 2 |
| 63 | 135011 | HEIGHT POINTER | | 1 |
| 64 | NH081300 | NUT | M8 | 1 |
| 65 | SH081800 | HEX HEAD LOLT | M8x90 | 1 |
| 66 | 135022 | KNOB SCREW | | 1 |
| 67 | 135020 | KNOB SCREW | | 1 |
| 68 | 135028 | LOCATE HANDLE | M10 | 1 |
| 69 | 135030 | CAM | | 1 |
| 70 | 135038 | LOCATE BLOCK | | 1 |
| 71 | 620021 | KNOB | | 1 |
| 72 | 620020 | LEVER ROD | | 1 |
| 73 | NH121900 | NUT | M12 | 1 |
| 74 | 135036 | SHAFT | | 1 |
| 75 | SJ080400 | HEX SOCKET BOTTOM HEAD SCREW | M8x20 | 4 |
| 76 | WS080000 | SPRING WASHER | M8 | 4 |
| 77 | WS060000 | SPRING WASHER | M6 | 2 |
| 78 | 135013 | COVER | | 1 |
| 79 | SS080400 | SET SCREW | M8x20 | 4 |
| 80 | NH081300 | NUT | M8 | 4 |
| 81 | 135005 | LOWER WHEEL SHAFT | | 1 |
| 82 | MH135005 | MOTOR | | 1 |
| 83 | SR100500 | HEX HEAD BOLT | M10x25 | 2 |
| 84 | WS100000 | SPRING WASHER | M10 | 2 |
| 85 | 135064 | MOTOR BRACKET | | 1 |
| 86 | SJ080400 | HEX SOCKET BOTTOM HEAD HEAD SCREW | M8x20 | 4 |
| 87 | 135056 | PLATE | | 1 |
| 88 | SF050200 | PAN HEAD BOLT W/FLANGE | M5x10 | 2 |
| 89 | 135065 | LOCATE BLOCK | | 1 |
| 90 | KS050535 | KEY | 5x5x35 | 1 |

| KEY NO. | PARTS NO. | DESCRIPTION | SIZE | Q'TY |
|---------|-----------|------------------------------|----------------|------|
| 91 | SH080402 | HEX HEAD BOLT | M8x20(L.H) | 1 |
| 92 | 135008 | MOTOR PULLEY | | 1 |
| 93 | LA440000 | V-BELT | A44 | 1 |
| 94 | SR060200 | HEX SOCKET BOLT | M6x10 | 1 |
| 95 | 136036 | LOWER WHEEL COVER | | 1 |
| 96 | WF061310 | FLAT WASHER | M6x13 | 2 |
| 97 | WF083030 | FLAT WASHER | M8x30 | 1 |
| 98 | SR100700 | HEX SOCKET BOLT | M10x35 | 2 |
| 99 | NH101700 | NUT | M10 | 1 |
| 100 | 135061 | SMALL GEAR | | 2 |
| 101 | 135063 | KNOB SCREW | | 1 |
| 102 | 135021 | TRUNNION SUPPORT BRACKET | | 1 |
| 103 | WS100000 | SPRING WASHER | M10 | 3 |
| 104 | WF102325 | FLAT WASHER | M10x ϕ 23 | 2 |
| 105 | SR069400 | HEX SOCKET BOLT | M6x16 | 1 |
| 106 | SR060900 | HEX SOCKET BOLT | M6x45 | 1 |
| 107 | 135045 | ADJUST BLOCK | | 1 |
| 108 | NH061000 | NUT | M6 | 2 |
| 109 | 135009 | ADJUST BOLT | M6 | 1 |
| 110 | BB600002 | BALL BEARING | 6000ZZ | 1 |
| 111 | SJ100400 | HEX SOCKET BOTTOM HEAD SCREW | M10x20 | 1 |
| 112 | WF081820 | FLAT WASHER | M8x ϕ 18 | 4 |
| 113 | WF081820 | FLAT WASHER | M8x ϕ 18 | 2 |
| 114 | SP049100 | PAN HEAD BOLT | M4x6 | 4 |
| 115 | 135052 | GEAR PLATE | | 2 |
| 116 | NL081300 | NYLOW NUT | M8 | 2 |
| 117 | SP049100 | PAN HEAD BOLT | M4x6 | 1 |
| 118 | 135044 | HANDLE | | 1 |
| 119 | WF040808 | FLAT WASHER | M4x ϕ 8 | 2 |
| 120 | 135078 | POINTER | | 1 |

| KEY NO. | PARTS NO. | DESCRIPTION | SIZE | Q'TY |
|---------|-----------|------------------------|-------|------|
| 121 | 135025 | TRUNNION PLATE | | 2 |
| 122 | WS080000 | SPRING WASHER | M8 | 4 |
| 123 | SH089400 | HEX HEAD BOLT | M8x16 | 4 |
| 124 | SC081600 | CARRIAGE BOLT | M8x80 | 1 |
| 125 | AB198004 | 20" FENCE SET | | 1 |
| | 198002 | ADJUST BASE | | 1 |
| | 198003 | FIXED SHAFT | | 2 |
| | 198004 | FIXED LUMP | | 1 |
| | 198005 | SHAFT | | 1 |
| | 198006 | SPRING PIECE | | 1 |
| | 198007 | CONVEX | | 1 |
| | 198008 | BRACKET | | 1 |
| | 198010 | SPACE BUSHING | | 2 |
| | 198012 | ADJUST SCREW | | 1 |
| | 198013 | HANDLE | | 1 |
| | 198014 | GUARD PIECE | | 2 |
| | 198015 | GUARD PIECE | | 2 |
| | 135016 | PLUG | | 2 |
| | 198026 | FIXED BASE | L-790 | 1 |
| | 198027 | SQUARE TUBE | L=790 | 1 |
| | 198028 | SUPPORT TUBE | L=690 | 1 |
| | LM000539 | SCALE | | 1 |
| | SF040200 | PAN HEAD BOLT W/FLANGE | M4x10 | 1 |
| | SH060400 | HEX HEAD BOLT | M6x20 | 2 |
| | SR069400 | HEX SOCKET BOLT | M6x16 | 2 |
| | NH061000 | NUT | M6 | 2 |
| | ST039200 | TAPPING SCREW | 3.5x8 | 4 |
| | SF049100 | PAN HEAD BOLT W/FLANGE | M4x6 | 2 |
| | NH081300 | NUT | M8 | 1 |
| | SR061100 | HEX SOCKET BOLT | M6x55 | 4 |

| KEY NO. | PARTS NO. | DESCRIPTION | SIZE | Q'TY |
|---------|-----------|---------------------------|---------------|------|
| | WS060000 | SPRING WASHER | M6 | 2 |
| 126 | 136034 | TABLE | 21"x21" | 1 |
| 127 | 135010 | TABLE INSERT | | 1 |
| 128 | 100038 | TABLE PIN | | 1 |
| 129 | SR069100 | HEX SOCKET BOLT | M6x6 | 2 |
| 130 | 135031 | LEFT COVER | | 1 |
| 131 | 150013 | THUMB SCREW | M6x16 | 2 |
| 132 | 135059 | LOWER BLADE GUIDE SUPPORT | | 1 |
| 133 | 135058 | GUIDE RING | | 2 |
| 134 | 135018 | LOWER ADJUST SHAFT | | 4 |
| 135 | 135035 | RIGHT COVER | | 1 |
| 136 | SR050200 | HEX SOCKET BOLT | M5x10 | 2 |
| 137 | WF051210 | FLAT WASHER | M5x ϕ 12 | 2 |
| 138 | 135034 | PROTECT COVER (ASM) | | 1 |
| 139 | | | | |
| 140 | 135073 | STEP SCREW | | 1 |
| 141 | 135054 | FLAT WASHER | | 1 |
| 142 | 135037 | SLIDING PLATE | | 1 |
| 143 | RS150000 | RETAINING RING | S15 | 1 |
| 144 | BB620202 | BALL BEARING | 6202ZZ | 1 |
| 145 | 135055 | UPPER BLADE GUIDE SUPPORT | | 1 |
| 146 | 135058 | GUIDE RING | | 2 |
| 147 | 150013 | THUMB SCREW | M6x16 | 2 |
| 148 | SC081700 | CARRIAGE BOLT | M8x85 | 1 |
| 149 | SR069400 | HEX SOCKET BOLT | M6x16 | 3 |
| 150 | 135053 | ADJUST BAR | | 1 |
| 151 | 135060 | UPPER SPACING SLEEVE | | 1 |
| 152 | SR060400 | HEX SOCKET BOLT | M6x20 | 2 |
| 153 | 135057 | UPPER GUIDE SUPPORT BLOCK | | 1 |
| 154 | SP040200 | PAN HEAD BOLT | M4x10 | 1 |

| KEY NO. | PARTS NO. | DESCRIPTION | SIZE | Q'TY |
|---------|-----------|------------------------------|-------|------|
| 155 | NH040700 | NUT | M4 | 1 |
| 156 | 135029 | RACK | | 1 |
| 157 | 135047 | UPPER GUIDE TUBE | | 1 |
| 158 | 135006 | HANDLE WHEEL | | 1 |
| 159 | SR060400 | HEX SOCKET BOLT | M6x20 | 1 |
| 160 | 135015 | LOCATE BUSHING | | 1 |
| 161 | 135043 | BUSHING | | 1 |
| 162 | SJ080400 | HEX SOCKET BOTTOM HEAD SCREW | M8x20 | 4 |
| 163 | WS080000 | SPRING WASHER | M8 | 9 |
| 164 | 135050 | GUIDE BRACKET | | 1 |
| 165 | 135033 | WORM CYLINDER | | 1 |
| 166 | 135062 | FIXED PLATE | | 1 |
| 167 | 135049 | GEAR | | 1 |
| 168 | 016320 | FIXED BOLT | | 1 |
| 169 | 135046 | COVER | | 1 |
| 170 | SR089400 | HEX SOCKET BOLT | M8x16 | 4 |
| 171 | SN049200 | COUNTER SUNK BOLT | M4x8 | 3 |
| 172 | SS069400 | SET BOLT | M6x16 | 1 |
| 173 | AB198101 | MITER GAUGE ASS'Y | | 1 |
| | 198101 | GUIDE BAR | | 1 |
| | 198102 | GUIDE | | 1 |
| | 198103 | POINTER | | 1 |
| | 198104 | NYLON WASHER | | 1 |
| | 198105 | HANDLE | 1/4" | 1 |
| | 198106 | MITER GAUGE BODY | | 1 |
| | 198107 | SHAFT | | 1 |
| | SN069200 | COUNTER SUNK BOLT | M6x6 | 1 |
| | SF059200 | PAN HEAD BOLT W/FLANGE | M5x8 | 1 |
| 174 | 135079 | BUSHING | | 1 |
| 175 | SR060400 | HEX SOCKET BOLT | M6X20 | 1 |
| 176 | SF050200 | PAN HEAD BOLT W/FLANGE | M5X10 | 2 |

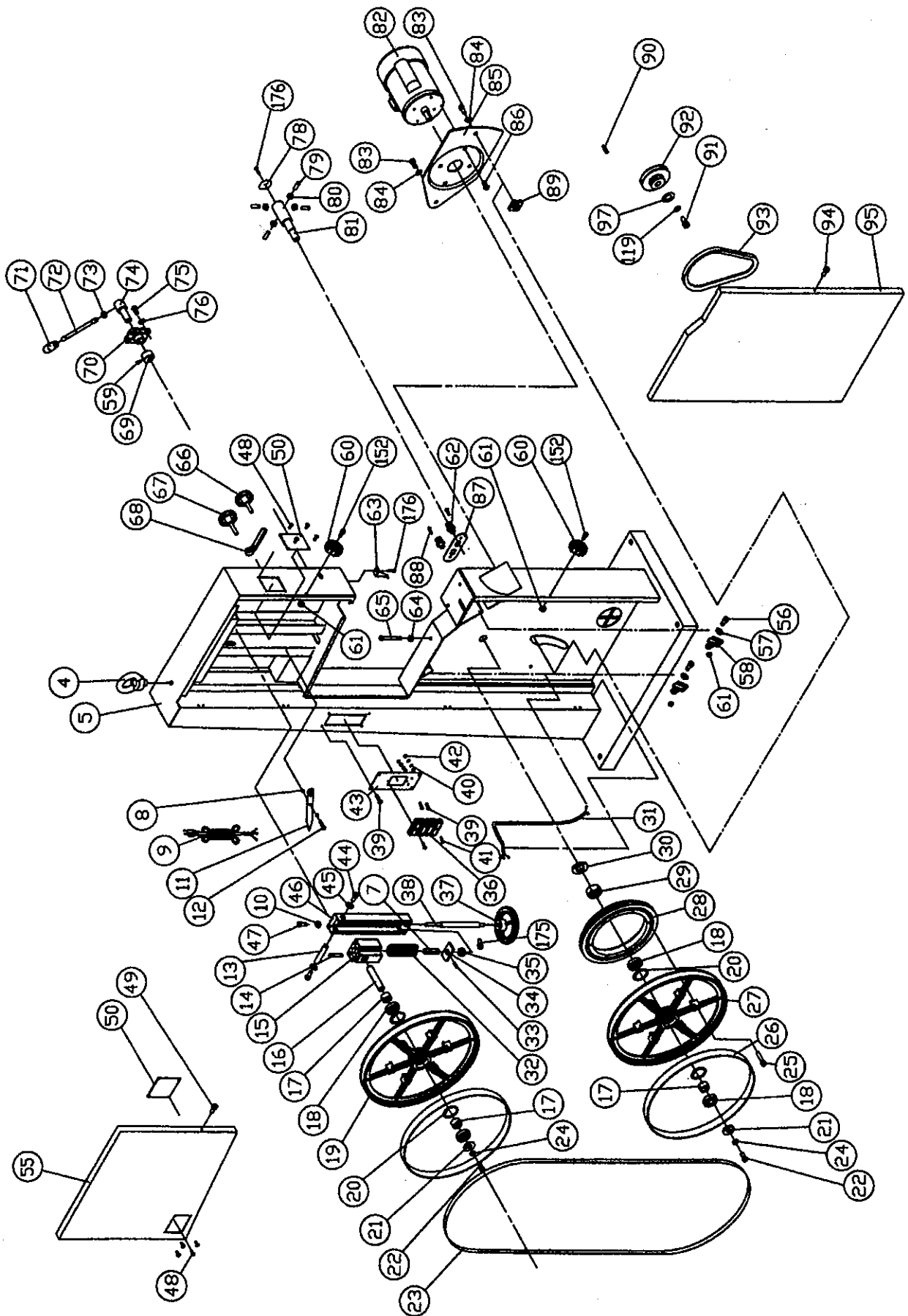

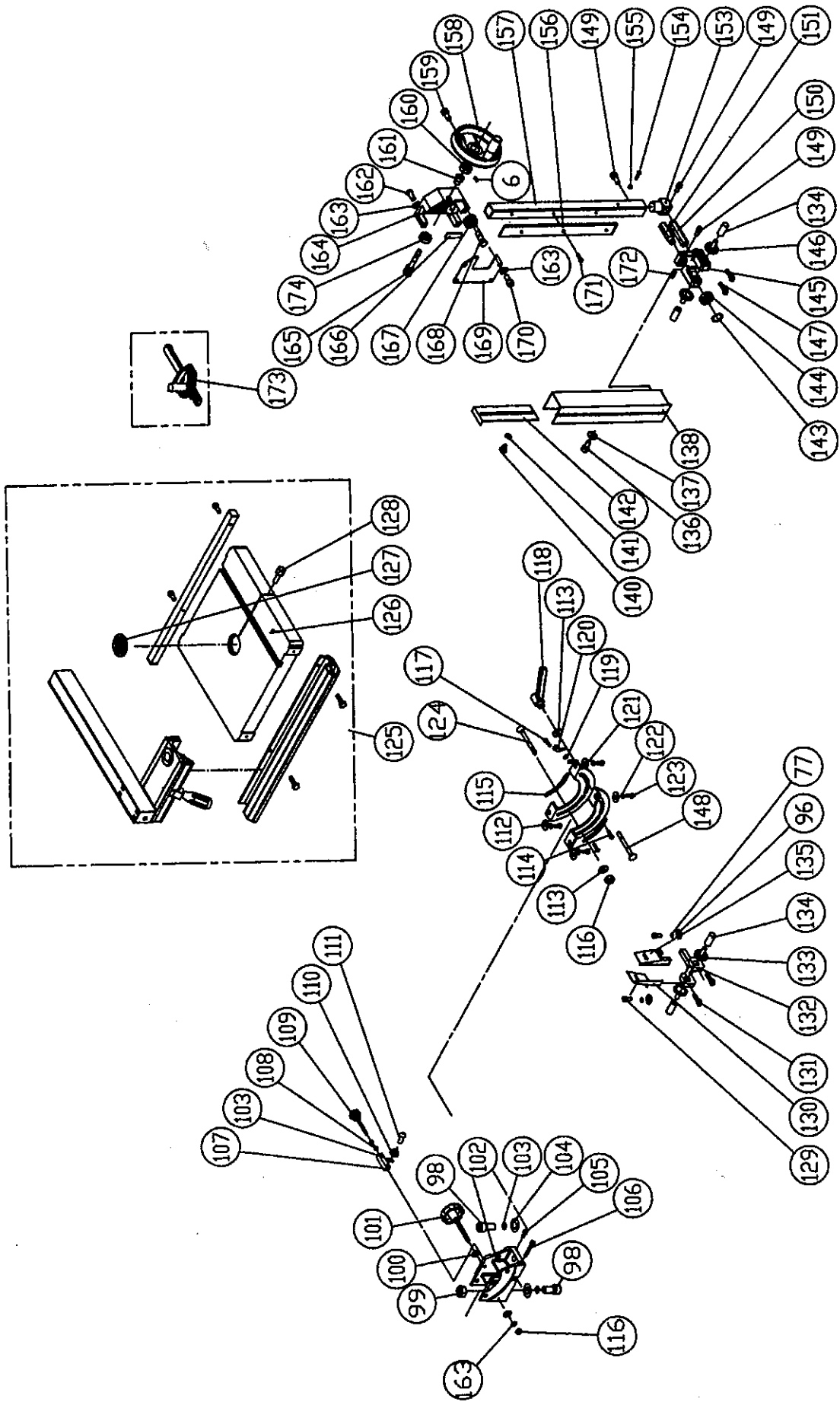

**Parts List For 21 Inch Band Saw
Model No .SBW-5300 CE**

| KEY NO. | PARTS NO. | DESCRIPTION | SIZE | Q'TY |
|---------|-----------|-------------------------|-----------------|------|
| 1 | 130040 | SWITCH COVER | | 1 |
| 2 | NH040700 | NUT | M4 | 2 |
| 3 | 709416 | STRAIN RELIEF | M16 | 1 |
| 4 | 995101 | RING | M10 | 1 |
| 5 | 136031 | MACHINE BODY | | 1 |
| 6 | SS050100 | SET BOLT | M5X5 | 2 |
| 7 | IC135002 | SWITCH CORD | | 1 |
| 8 | WF061310 | FLAT WASHER | M6x ϕ 13 | 2 |
| 9 | IC135001 | POWER CORD | | 1 |
| 10 | NH061000 | NUT | M6 | 1 |
| 11 | 135040 | POINTER | | 1 |
| 12 | 135073 | STEP SCREW | | 1 |
| 13 | 135012 | UPPER SHAFT | | 1 |
| 14 | PS053500 | SPRING PIN | ϕ 5x35 | 2 |
| 15 | 135017 | UPPER WHEEL SHAFT HINGE | | 1 |
| 16 | 135066 | UPPER WHEEL SHAFT | | 1 |
| 17 | 135039 | BUSHING | | 3 |
| 18 | BB620403 | BALL BEARING | 6204LLU | 4 |
| 19 | 136002 | UPPER WHEEL | ϕ 21" | 1 |
| 20 | RR470000 | RETAINING RING | R47 | 4 |
| 21 | WF083030 | FLAT WASHER | M8x ϕ 30 | 2 |
| 22 | SR089400 | HEX SOCKET BOLT | M8X16 | 2 |
| 23 | 136010 | SAW BLADE | 152"x3/4"X0.5mm | 1 |
| 24 | WS080000 | SPRING WASHER | M8 | 2 |
| 25 | SR060600 | HEX SOCKET BOLT | M6x30 | 6 |
| 26 | 135040 | TIRE | | 2 |
| 27 | 136003 | LOWER WHEEL | ϕ 21" | 1 |
| 28 | 135007 | IDLE PULLEY | | 1 |
| 29 | NH633801 | NUT | 1"-14 UNF | 1 |
| 30 | WS630000 | SPRING WASHER | 1" | 1 |

| KEY NO. | PARTS NO. | DESCRIPTION | SIZE | Q'TY |
|---------|-----------|-----------------------------|----------|------|
| 31 | IM135001 | MOTOR CORD | | 1 |
| 32 | 135032 | SPRING | | 1 |
| 33 | PS031600 | PIN | φ 3X16 | 1 |
| 34 | 135042 | LOCATE BLOCK | | 1 |
| 35 | 994301 | BUSHING | | 1 |
| 36 | 170245 | CE SWITCH | JD2 | 1 |
| 37 | 135002 | HANDLE WHEEL | | 1 |
| 38 | 136037 | ADJUSTING BOLT | | 1 |
| 39 | SF050200 | PAN HEAD BOLT W/FLANGE | M5X10 | 8 |
| 40 | WE050000 | STAR WASHER | M5 | 4 |
| 41 | 135067 | BUSHING | | 1 |
| 42 | NH050800 | NUT | M5 | 4 |
| 43 | 135070 | SWITCH PLATE | | 1 |
| 44 | SR089400 | HEX SOCKET BOLT | M8x16 | 2 |
| 45 | WF083030 | FLAT WASHER | M8x φ 30 | 2 |
| 46 | 135016 | UPPER WHEEL SLIDING BRACKET | | 1 |
| 47 | SR061000 | HEX SOCKET BOLT | M5x50 | 1 |
| 48 | BR000041 | RIVET | φ 3.2x6 | 8 |
| 49 | SR060200 | HEX SOCKET BOLT | M6x10 | 1 |
| 50 | 135004 | LIMPID PIECE | | 2 |
| 51 | SF040600 | PAN HEAD BOLT W/FLANGE | M4x30 | 2 |
| 52 | 136012 | DOOR LATCH SWITCH (ASM) | | 1 |
| 53 | SF050200 | PAN HEAD BOLT W/FLANGE | M5x10 | 4 |
| 54 | 136009 | SWITCH BUSHING | | 1 |
| 55 | 136035 | UPPER WHEEL COVER | | 1 |
| 56 | SR060500 | HEX SOCKET BOLT | M6x25 | 2 |
| 57 | WF061310 | FLAT WASHER | M6x φ 13 | 2 |
| 58 | 135051 | BRUSH | | 2 |
| 59 | SR060500 | HEX SOCKET BOLT | M6x25 | 1 |
| 60 | 135041 | KNOB | | 2 |

| KEY NO. | PARTS NO. | DESCRIPTION | SIZE | Q'TY |
|---------|-----------|------------------------------|--------|------|
| 61 | NL061000 | NYLON NUT | M6 | 4 |
| 62 | 709416 | STRAIN RELIEF | M16 | 2 |
| 63 | 135011 | HEIGHT POINTER | | 1 |
| 64 | NH081300 | NUT | M8 | 1 |
| 65 | SH081800 | HEX HEAD LOLT | M8x90 | 1 |
| 66 | 135022 | KNOB SCREW | | 1 |
| 67 | 135020 | KNOB SCREW | | 1 |
| 68 | 135028 | LOCATE HANDLE | M10 | 1 |
| 69 | 135030 | CAM | | 1 |
| 70 | 135038 | LOCATE BLOCK | | 1 |
| 71 | 620021 | LEVER ROD | | 1 |
| 72 | 620020 | KNOB | | 1 |
| 73 | NH121900 | NUT | M12 | 1 |
| 74 | 135036 | SHAFT | | 1 |
| 75 | SJ080400 | HEX SOCKET BOTTOM HEAD SCREW | M8x20 | 4 |
| 76 | WS080000 | SPRING WASHER | M8 | 4 |
| 77 | WS060000 | SPRING WASHER | M6 | 2 |
| 78 | 135013 | COVER | | 1 |
| 79 | SS080400 | SET SCREW | M8x20 | 4 |
| 80 | NH081300 | NUT | M8 | 4 |
| 81 | 135005 | LOWER WHEEL SHAFT | | 1 |
| 82 | MH135004 | MOTOR | 2 HP | 1 |
| 83 | SR100500 | HEX HEAD BOLT | M10x25 | 2 |
| 84 | WS100000 | SPRING WASHER | M10 | 2 |
| 85 | 135064 | MOTOR BRACKET | | 1 |
| 86 | SJ080400 | HEX SOCKET BOTTOM HEAD SCREW | M8x20 | 4 |
| 87 | 135056 | PLATE | | 1 |
| 88 | SF050200 | PAN HEAD BOLT W/FLANGE | M5x10 | 2 |
| 89 | 135065 | LOCATE BLOCK | | 1 |
| 90 | KS050535 | KEY | 5x5x35 | 1 |

| KEY NO. | PARTS NO. | DESCRIPTION | SIZE | Q'TY |
|---------|-----------|------------------------------|----------------|------|
| 91 | SH080402 | HEX HEAD BOLT | M8x20(L.H) | 1 |
| 92 | 135008 | MOTOR PULLEY | | 1 |
| 93 | LA440000 | V-BELT | A44 | 1 |
| 94 | SR060200 | HEX SOCKET BOLT | M6x10 | 1 |
| 95 | 136036 | LOWER WHEEL COVER | | 1 |
| 96 | WF061310 | FLAT WASHER | M6x13 | 2 |
| 97 | WF083030 | FLAT WASHER | M8x30 | 1 |
| 98 | SR100700 | HEX SOCKET BOLT | M10x35 | 2 |
| 99 | NH101700 | NUT | M10 | 1 |
| 100 | 135061 | SMALL GEAR | | 2 |
| 101 | 135063 | KNOB SCREW | | 1 |
| 102 | 135021 | TRUNNION SUPPORT BRACKET | | 1 |
| 103 | WS100000 | SPRING WASHER | M10 | 3 |
| 104 | WF102325 | FLAT WASHER | M10x ϕ 23 | 2 |
| 105 | SR069400 | HEX SOCKET BOLT | M6x16 | 1 |
| 106 | SR060900 | HEX SOCKET BOLT | M6x45 | 1 |
| 107 | 135045 | ADJUST BLOCK | | 1 |
| 108 | NH061000 | NUT | M6 | 2 |
| 109 | 135009 | ADJUST BOLT | M6 | 1 |
| 110 | BB600002 | BALL BEARING | 6000ZZ | 1 |
| 111 | SJ100400 | HEX SOCKET BOTTOM HEAD SCREW | M10x20 | 1 |
| 112 | WF081820 | FLAT WASHER | M8x ϕ 18 | 4 |
| 113 | WF081820 | FLAT WASHER | M8x ϕ 18 | 2 |
| 114 | SP049100 | PAN HEAD BOLT | M4x6 | 4 |
| 115 | 135052 | GEAR PLATE | | 2 |
| 116 | NL081300 | NYLON NUT | M8 | 2 |
| 117 | SP049100 | PAN HEAD BOLT | M4x6 | 1 |
| 118 | 135044 | HANDLE | | 1 |
| 119 | WF040808 | FLAT WASHER | M4x ϕ 8 | 2 |
| 120 | 135078 | POINTER | | 1 |

| KEY NO. | PARTS NO. | DESCRIPTION | SIZE | Q'TY |
|---------|-----------|------------------------|-------|------|
| 121 | 135025 | TRUNNION PLATE | | 2 |
| 122 | WS080000 | SPRING WASHER | M8 | 4 |
| 123 | SH089400 | HEX HEAD BOLT | M8x16 | 4 |
| 124 | SC081600 | CARRIAGE BOLT | M8x80 | 1 |
| 125 | Ab198004 | 20" FENCE SET | | 1 |
| | 198002 | ADJUST BASE | | 1 |
| | 198003 | FIXED SHAFT | | 2 |
| | 198004 | FIXED LUMP | | 1 |
| | 198005 | SHAFT | | 1 |
| | 198006 | SPRING PIECE | | 1 |
| | 198007 | CONVEX | | 1 |
| | 198008 | BRACKET | | 1 |
| | 198010 | SPACE BUSHING | | 2 |
| | 198012 | ADJUST SCREW | | 1 |
| | 198013 | HANDLE | | 1 |
| | 198014 | GUARD PIECE | | 2 |
| | 198015 | GUARD PIECE | | 2 |
| | 198016 | PLUG | | 2 |
| | 198026 | FIXED BASE | L=790 | 1 |
| | 198027 | SQUARE TUBE | L=790 | 1 |
| | 198028 | SQUARE TUBE | L=690 | 1 |
| | LM000539 | SCALE | | 1 |
| | SF040200 | PAN HEAD BOLT W/FLANGE | M4x10 | 1 |
| | SH060400 | HEX HEAD BOLT | M6x20 | 2 |
| | SR069400 | HEX SOCKET BOLT | M6x16 | 2 |
| | NH061000 | NUT | M6 | 2 |
| | ST039200 | TAPPING SCREW | 3.5x8 | 4 |
| | SF049100 | PAN HEAD BOLT W/FLANGE | M4x6 | 2 |
| | NH081300 | NUT | M8 | 1 |
| | SR061100 | HEX SOCKET BOLT | M6x55 | 4 |

| KEY NO. | PARTS NO. | DESCRIPTION | SIZE | QTY |
|---------|-----------|---------------------------|---------------|-----|
| | WS060000 | SPRING WASHER | M6 | 2 |
| 126 | 136004 | TABLE | 21"x21" | 1 |
| 127 | 135010 | TABLE INSERT | | 1 |
| 128 | 100038 | TABLE PIN | | 1 |
| 129 | SR069100 | HEX SOCKET BOLT | M6x6 | 2 |
| 130 | 135031 | LEFT COVER | | 1 |
| 131 | 150013 | THUMB SCREW | M6x16 | 2 |
| 132 | 135059 | LOWER BLADE GUIDE SUPPORT | | 1 |
| 133 | 135058 | GUIDE RING | | 2 |
| 134 | 135018 | LOWER ADJUST SHAFT | | 4 |
| 135 | 135035 | RIGHT COVER | | 1 |
| 136 | SR050200 | HEX SOCKET BOLT | M5x10 | 2 |
| 137 | WF051210 | FLAT WASHER | M5x ϕ 12 | 2 |
| 138 | 135034 | PROTECT COVER (ASM) | | 1 |
| 139 | | | | |
| 140 | 135073 | STEP SCREW | | 1 |
| 141 | 135054 | FLAT WASHER | | 1 |
| 142 | 135037 | SLIDING PLATE | | 1 |
| 143 | RS150000 | RETAINING RING | S15 | 1 |
| 144 | BB620202 | BALL BEARING | 6202ZZ | 1 |
| 145 | 135055 | UPPER BLADE GUIDE SUPPORT | | 1 |
| 146 | 135058 | GUIDE RING | | 2 |
| 147 | 150013 | THUMB SCREW | M6x16 | 2 |
| 148 | SC081700 | CARRIAGE BOLT | M8x85 | 1 |
| 149 | SR069400 | HEX SOCKET BOLT | M6x16 | 3 |
| 150 | 135053 | ADJUST BAR | | 1 |
| 151 | 135060 | UPPER SPACING SLEEVE | | 1 |
| 152 | SR060400 | HEX SOCKET BOLT | M6x20 | 2 |
| 153 | 135057 | UPPER GUIDE SUPPORT BLOCK | | 1 |
| 154 | SP040200 | PAN HEAD BOLT | M4x10 | 1 |

| KEY NO. | PARTS NO. | DESCRIPTION | SIZE | Q'TY |
|---------|-----------|------------------------------|-------|------|
| 155 | NH040700 | NUT | M4 | 1 |
| 156 | 135029 | RACK | | 1 |
| 157 | 135047 | UPPER GUIDE TUBE | | 1 |
| 158 | 135006 | HANDLE WHEEL | | 1 |
| 159 | SR060400 | HEX SOCKET BOLT | M6x20 | 1 |
| 160 | 135015 | LOCATE BUSHING | | 1 |
| 161 | 135043 | BUSHING | | 1 |
| 162 | SJ080400 | HEX SOCKET BOTTOM HEAD SCREW | M8x20 | 4 |
| 163 | WS080000 | SPRING WASHER | M8 | 9 |
| 164 | 135050 | GUIDE BRACKET | | 1 |
| 165 | 135033 | WORM CYLINDER | | 1 |
| 166 | 135062 | FIXED PLATE | | 1 |
| 167 | 135049 | GEAR | | 1 |
| 168 | 016320 | FIXED BOLT | | 1 |
| 169 | 135046 | COVER | | 1 |
| 170 | SR089400 | HEX SOCKET BOLT | M8x16 | 4 |
| 171 | SN049200 | COUNTER SUNK BOLT | M4x8 | 3 |
| 172 | SS069400 | SET BOLT | M6x16 | 1 |
| 173 | AB198101 | MITER GAUGE ASS'Y | | 1 |
| | 198101 | GUIDE BAR | | 1 |
| | 198102 | GUIDE | | 1 |
| | 198103 | POINTER | | 1 |
| | 198104 | NYLON WASHER | | 1 |
| | 198105 | HANDLE | 1/4" | 1 |
| | 198106 | MITER GAUGE BODY | | 1 |
| | 198107 | SHAFT | | 1 |
| | SN069200 | COUNTER SUNK BOLT | M6x6 | 1 |
| | SN059200 | PAN HEAD BOLT W/FLANGE | M5x8 | 1 |
| 174 | 135079 | BUSHING | | 1 |
| 175 | SR060400 | HEX SOCKET BOLT | M6x20 | 1 |
| 176 | SF050200 | PAN HEAD BOLT W/FLANGE | M5x10 | 2 |

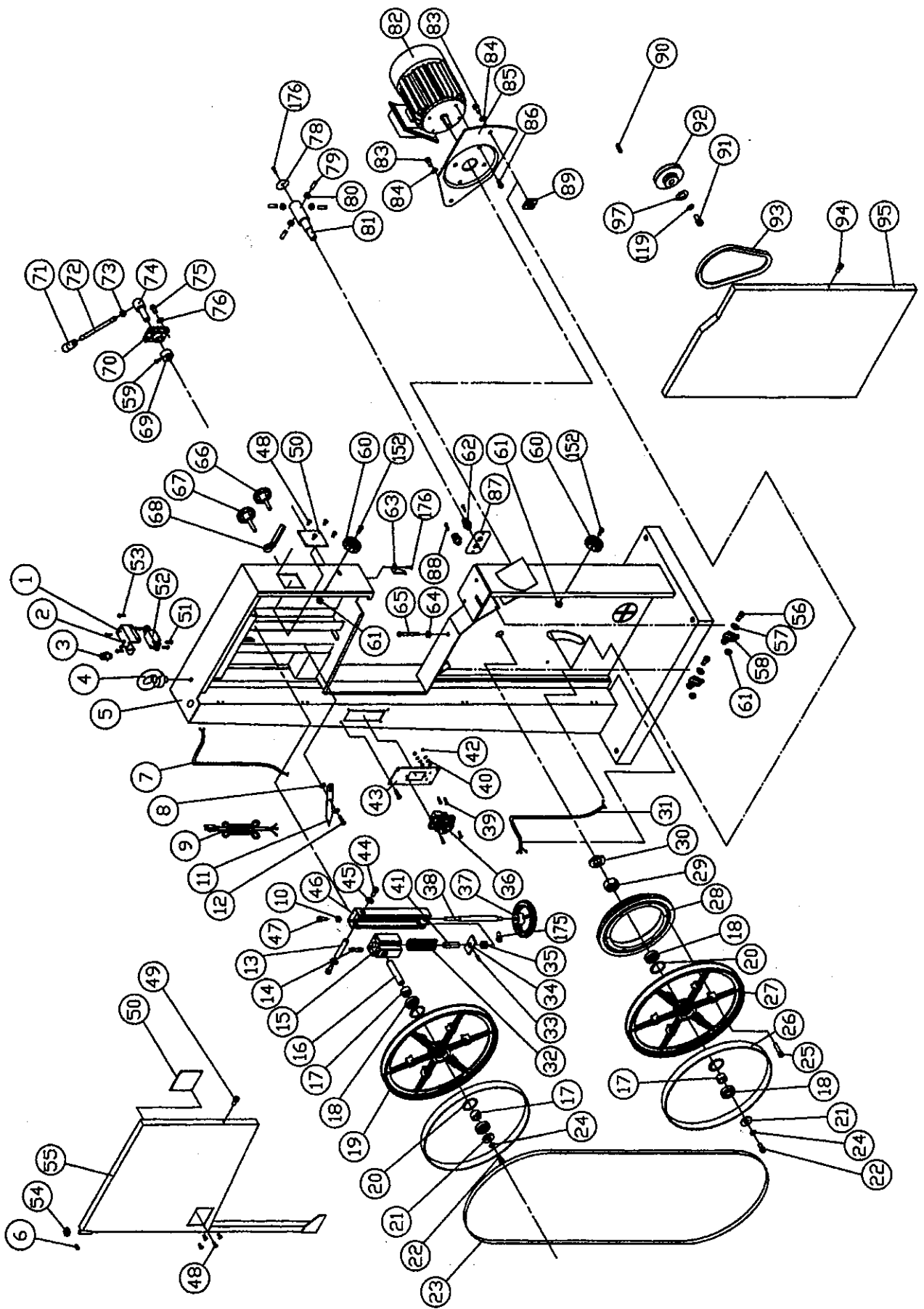

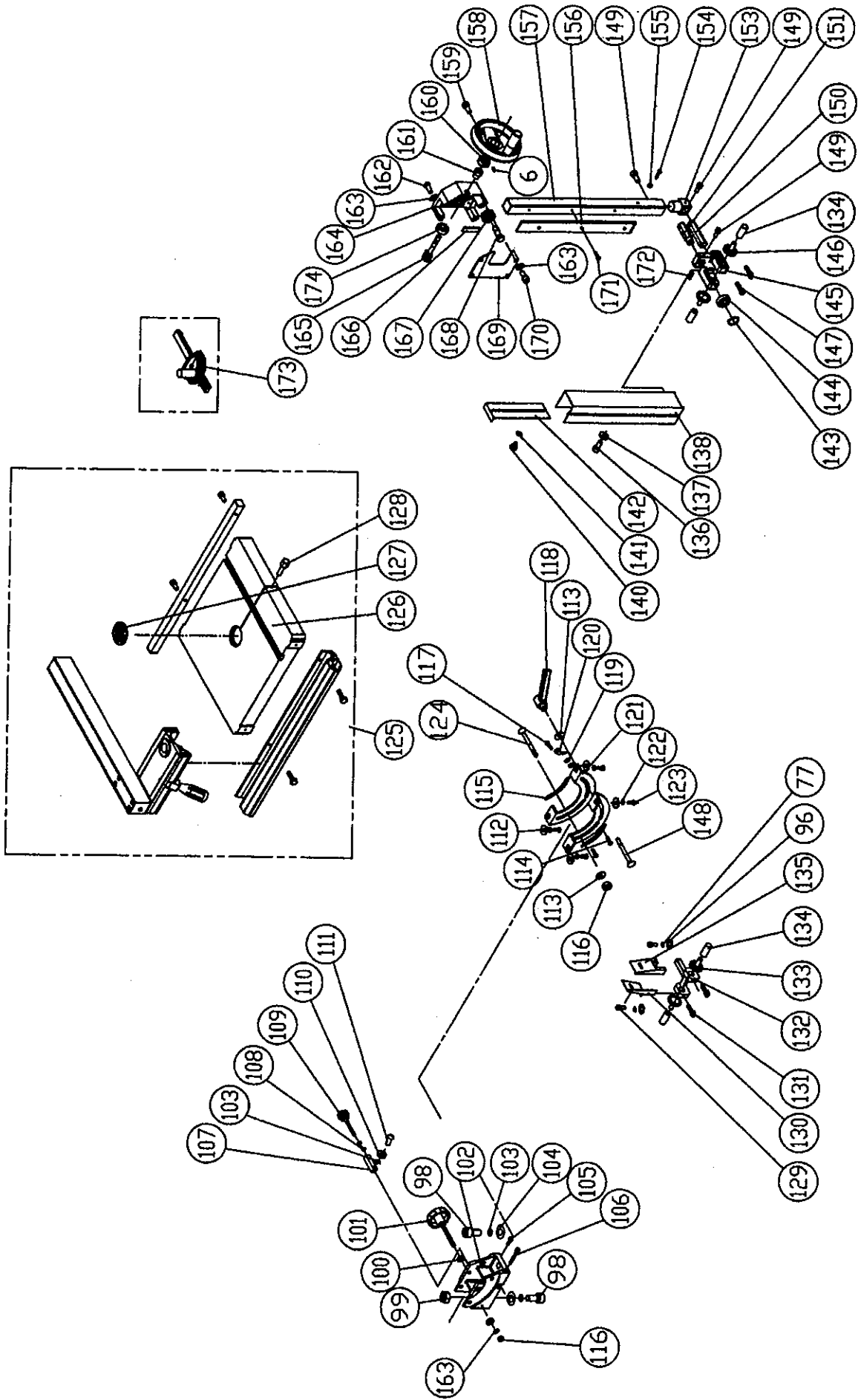

**Parts List For 21 Inch Band Saw
Model No.:QF198004
Rip Fence**

| KEY NO. | PARTS NO. | DESCRIPTION | SIZE | Q'TY |
|---------|-----------|------------------------|-------|------|
| 1 | 198026 | FIXED BASE | 790 | 1 |
| 2 | 198002 | ADJUST BASE | | 1 |
| 3 | 198003 | FIXED SHGAFT | | 2 |
| 4 | 198005 | SHAFT | | 1 |
| 5 | 198006 | SPRING PIECE | | 1 |
| 6 | 198008 | BRACKET | T=3 | 1 |
| 7 | 198028 | SUPPORT TUBE | 740 | 1 |
| 8 | 198010 | INTERVAL SHEATH | | 4 |
| 9 | 198013 | HANDLE | | 1 |
| 10 | 198012 | ADJUST SCREW | | 1 |
| 11 | 198007 | CONVEX | | 1 |
| 12 | SR061103 | HEX SOCKET BOLT | M6x55 | 4 |
| 13 | 198004 | FIXED LUMP | | 1 |
| 14 | 198027 | SQUARE TUBE | 790 | 1 |
| 15 | NH081300 | NUT | M8 | 1 |
| 16 | SF049100 | PAN HEAD BOLT W/FLANGE | M4x6 | 2 |
| 17 | 198014 | GUARD PIECE | | 2 |
| 18 | 198015 | GUARD PIECE | | 2 |
| 19 | 198016 | PLUGGED | | 2 |
| 20 | ST039200 | TAPPING SCREW | 3.5x8 | 4 |
| 21 | LM000539 | SCALE | | 1 |
| 22 | NH061000 | NUT | M6 | 2 |
| 23 | WS060000 | SPRING WASHER | M6 | 2 |
| 24 | SR069400 | HEX SOCKET BOLT | M6x16 | 2 |
| 25 | SH060400 | HEX HEAD BOLT | M6x20 | 2 |
| 26 | SF040200 | PAN HEAD BOLT W/FLANGE | M4x10 | 1 |
| | | | | |
| | | | | |
| | | | | |
| | | | | |

